

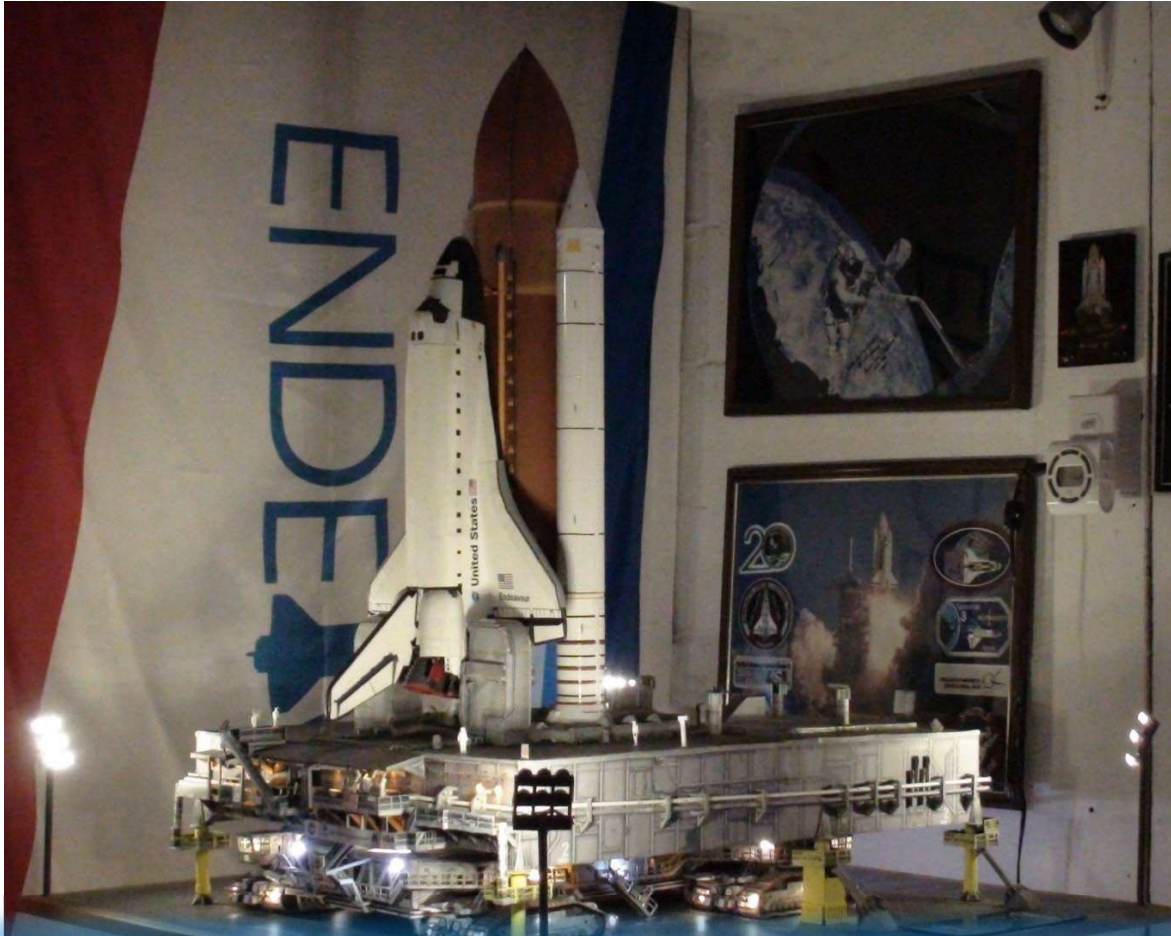

Lake County SpacePort

"Ad Astra Per Formae"

2024 Space Modeling Detailing Products Catalog



Space Modeling Detailing Products Catalog

We are pleased to offer a selection of specialized Space Shuttle modeling products, the result of our work here at the Space Port, in the hope that they will help you build the best model you can build.

NOTE - These items are available for sale on our Website directly as well as on eBay. Quantities will deplete from time to time.

If an item is not available when you put in an order from this site, you will get an email update, informing you when the next production batch is to become available. You can decide to wait and order when available or you can keep your order open for completion upon the production of new inventory.

When you click on the price of any item, you will open the "Contact Us / Order from Us" page, in which you can provide your shipping information, email address, and the items you wish to purchase. LCSP will then reply with a Pay Pal invoice, for all items, plus shipping.

The prices shown here do not include shipping. Shipping costs will be calculated and shown on the invoice at the time of payment. As we use USPS Priority Flat Rate Shipping, U.S. Domestic 2-3 day Service is typically \$8.

International Priority Mail costs will be higher and will depend on the destination country.

Since USPS Priority Mail Flat Rate Shipping covers up to 70 lbs. (!), for one price, it is best to "bundle" your purchases together, rather than pay for multiple shipping fees!



Recommended Detailing Combinations for Specific Space Shuttle Orbiter Modeling Projects for
1/72, 1/100 and 1/144 scales

OV-101 "Enterprise"

OV-102 "Columbia"

OV-099 "Challenger"

Space Shuttle Standard Black Tile Decal Set (STS-STD-1-xxx)

Early Era Shuttle Additional White Tile Decal Set (STS-ETD-1-xxx)

Optional -

Space Shuttle Payload Bay Detail Set (STS-PDS-1-xxx) – (if Payload Bay Doors are to be open)

Space Shuttle Detail Applications Set (STS-DAS-1-xxx)

There are other detail part and decal suppliers whose products are those which we have used ourselves in our own Space Shuttle modeling projects, as shown on the LakeCountySpacePort.com website.

A complete list of those parts and decal suppliers, for both 1/72 and 1/144 scale models, are provided in a separate Supplier Index, provided on Page 4.



Recommended Detailing Combinations for Specific Space Shuttle Orbiter Modeling Projects for
1/72, 1/100 and 1/144 scales

OV-103 "Discovery"

OV-104 "Atlantis"

OV-105 "Endeavour"

A & B - Space Shuttle Standard Black Tile Decal Set (STS-STD-1-xxx)

A - Shuttle Orbiter AFRSI (Tape-Based) Replication Process Guide (Free PDF) and
Late Era Shuttle White Tile Decal Sheet - STS-LTD-1-72 (In 1/72 scale only), Or

B - Alternate Option – Shuttle Late Era Shuttle AFRSI & White Tile Decal Set (STS-LAD-1-xxx)

Optional -

Space Shuttle Payload Bay Detail Set (STS-PDS-1-xxx) (if Payload Bay Doors are to be open)

Space Shuttle Detail Applications Set (STS-DAS-1-xxx)

There are other detail part and decal suppliers whose products are those which we have used ourselves in our own Space Shuttle modeling projects, as shown on the LakeCountySpacePort.com website.

A complete list of those parts and decal suppliers, for both 1/72 and 1/144 scale models, are provided in a separate Supplier Index, provided on Page 4.



Space Shuttle Detail Parts from Noted Vendors Price (re Jan. 2024)

The suppliers shown are those that we have used ourselves in our own Shuttle modeling projects.

New Ware - (Link - <http://mek.kosmo.cz/newware/>)

NW006 1/144 Space Shuttle Upgrade	\$27.00
NW131 1/144 Space Shuttle with Boosters for REVELL	\$63.00
NW134 1/144 Space Shuttle Orbiter for REVELL	\$35.00
NW143 1/144 Space Shuttle Orbiter for AIRFIX	\$35.00

Real Space Models (Link - <http://realspacemodels.com>)

1/144 Space Shuttle Main Engines (includes. OMS engines)	\$10.00
1/72 Payload Bay Detail Set (resin & PE) – (Currently shown as “Sold Out”)	\$95.00
1/72 Space Shuttle Main Engines (includes OMS engines)	\$20.00

Shapeways – NiParts - (Link - <http://Shapeways.com/shops/niparts>)

1/72 scale SRB Aft Skirts (pair)	\$132.59
1/72 Scale SRB Heat Shields (pair)	\$25.00
1/72 SRB Tops (no Motors) (pair)	\$61.37
1/72 scale SRB Motors Assem2 (pair)	\$8.67
1/72 External Tank Umbilical and Cross Member	\$16.89
1/72 scale External Tank Intertank	\$57.64
1/72 scale Ice Frost ramps (ET) (set of 18)	\$12.30
1/72 scale (SRB) ET Attach Ring Assembly (pair)	\$21.76
1/72 Orbital Docking System – Detail parts	\$22.43
1/72 Orbital Docking System Main Body & Frame	\$17.23
1/72 Space Shuttle ODS Complete Assembly	no longer available
1/72 scale Space Shuttle OMS Engine w/Cover (each)	\$10.92
1/72 Scale Space Shuttle SSME (each)	\$22.56
1/144 Scale Space Shuttle SSME (each)	\$7.17

HD Modelworks via Shapeways – (Link - <http://shapeways.com/shops/hdmodelworks>)

1/72 Space Shuttle OMS Engines (pair)	\$18.43
1/144 Space Shuttle OMS Engines (pair)	\$7.78

UpDraft Model Works, Ltd. – (Link – <http://updraftmodels.com>)

Space Shuttle Main Engines – 1/72 scale	\$30.00
Space Shuttle Wheels – 1/72 scale (for Revell)	\$20.00
Space Shuttle Wheels - 1/72 scale (for Monogram)	\$20.00
Space Shuttle Forward RCS Module (1/72 scale – for Revell)	\$30.00
Space Shuttle Cockpit Update Set (1/72 scale-for Revell)	\$45.00
Space Shuttle Main Engines – 1/100 scale	\$20.00
Space Shuttle Main Engines – 1/144 scale	\$15.00
Space Shuttle Vertical Stabilizer, Late Era – 1/144 scale	\$20.00
Space Shuttle Vertical Stabilizer, Late Era w/SILTS Pod – 1/144 scale	\$20.00
Space Shuttle Body Flap – 1/144 scale	\$15.00

Figurative Studies – Open Edition - Max Grueter via Shapeways – (<https://www.shapeways.com/shops/grueter>)

NASA Space Shuttle Pilot (1/72)	\$ 6.05
NASA Space Shuttle Crew Mission Specialist (1/72)	\$11.77
NASA Astronaut / CANADARM Position (1/72)	\$ 6.81
Space Shuttle Crew Combo (1/144)	\$10.58
Space Shuttle Crew Combo (1/72)	\$23.96

Note: All prices shown are for the most cost-effective material –Versatile Plastic. “Fine Detail Plastic versions are available at additional cost. Shuttle Astronaut w/MMU no longer available separately – only as part of Shuttle Crew Combo.

There are many other small, independent model product producers offering specialized components for Space Shuttle modeling projects. Try checking them out by doing your own Web-based research before you begin building!

Orbiter Tile Layout

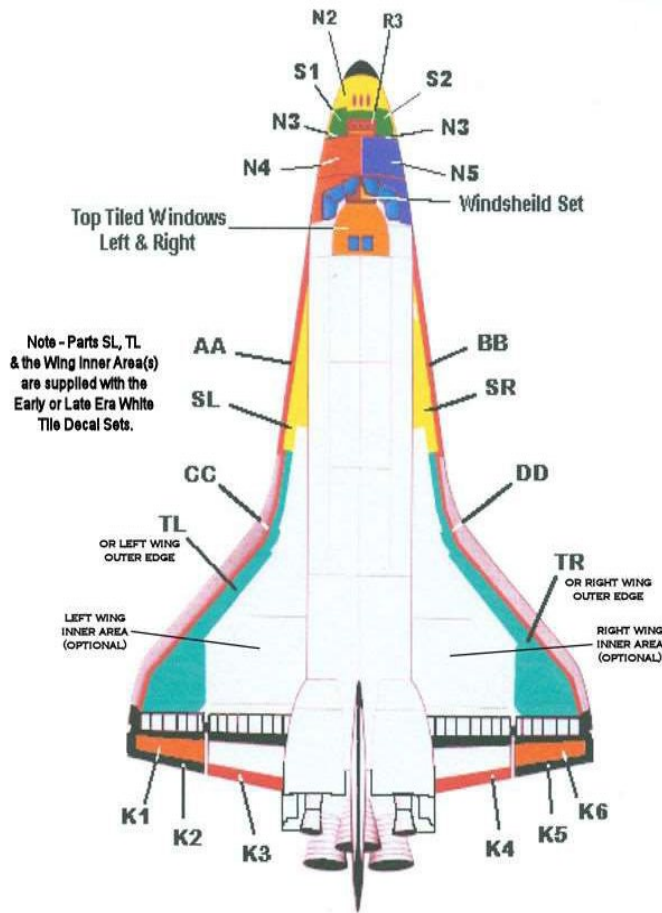

Note - Parts SL, TL & the Wing Inner Area(s) are supplied with the Early or Late Era White Tile Decal Sets.

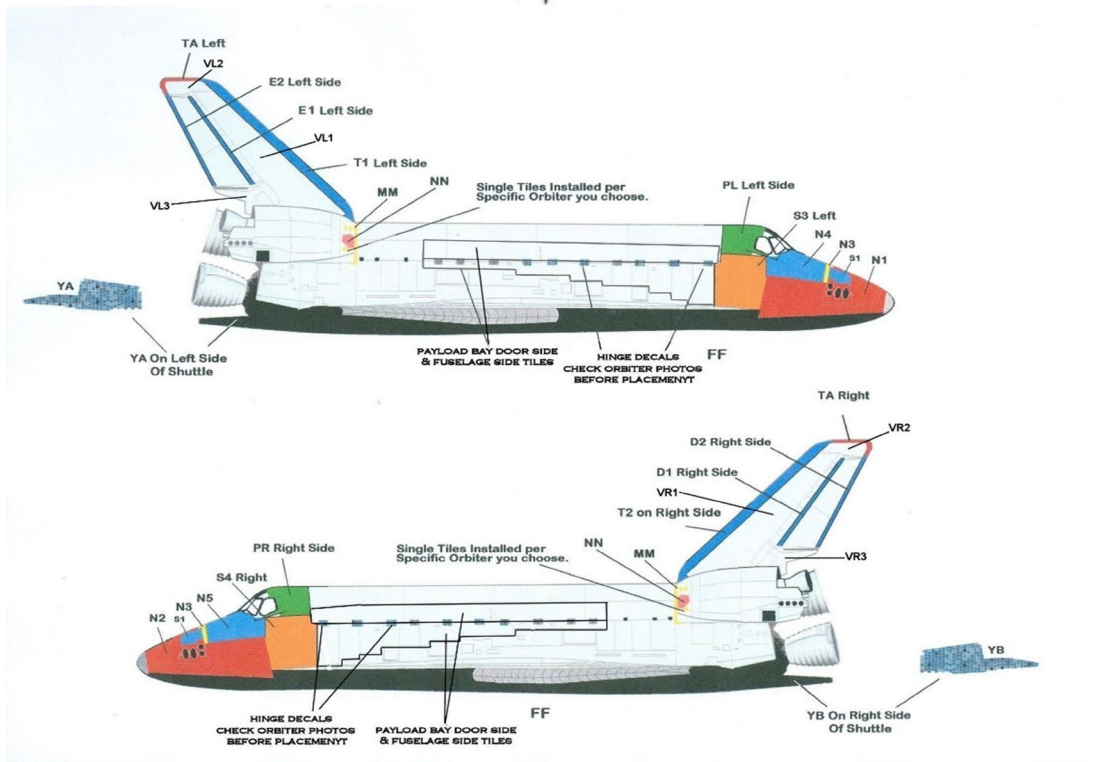

Standard Space Shuttle Black Tile Decal Set - 1/72, 1/100 & 1/144 scale

STS-STD-1-72 for 1/72 - \$50.00 - STS-STD-1-100 for 1/100 - \$40.00 - STS-STD-1-144 for 1/144 - \$30.00

The Lake County Space Port "Standard" Orbiter Tile Decal Set includes all of the "black" Thermal Protection System (TPS) areas which are common to all Space Shuttle Orbiters. The set includes three full-size sheets and two partial-sized sheets, which contain the following TPS areas:

- Port Underside – Wing and bottom to center Starboard Underside – Wing to bottom center Port Nose Underside
- Starboard Nose Underside
- Port Nose Side (includes Port RCS Bank)
- Starboard Nose Side (includes Starboard RCS Bank) Nose Upper RCS Bank
- Upper Wing Fillers
- Vertical Stabilizer Front Edges Aft Thrust Structure
- Body Flap (top & bottom)

Full-color instructions are included with the decal set.

The Standard Tile Decal Set must be paired with a specific White Tile/Blanket Decal Set to complete the overall TPS system for the specific Orbiter you are modelling.

>>the Early Era Shuttle White Tile Decals Set.

>>the Late Era Shuttle AFRSI & White Tile Decal Set.

>>>the Late Era Shuttle White Tile Decal Sheet and the Flexible Reusable Surface Insulation Application Method, which uses a specific Johnson & Jonson "Band-Aid Brand Cloth tape, to replicate the texture of the FRSI "blankets."

We manufacture these sets by hand, in small batches, typically five or six sets at a time.

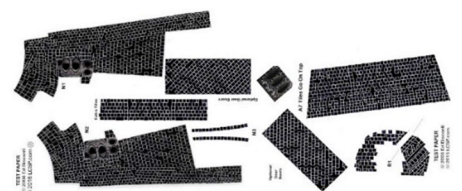
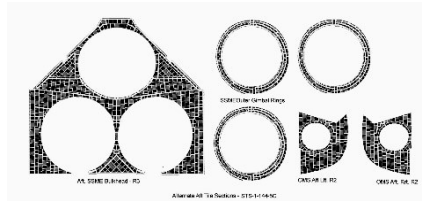
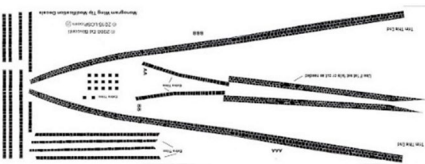
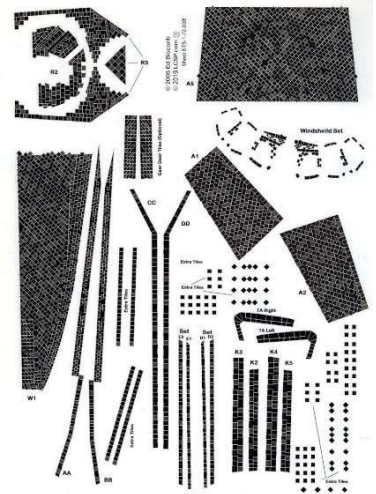
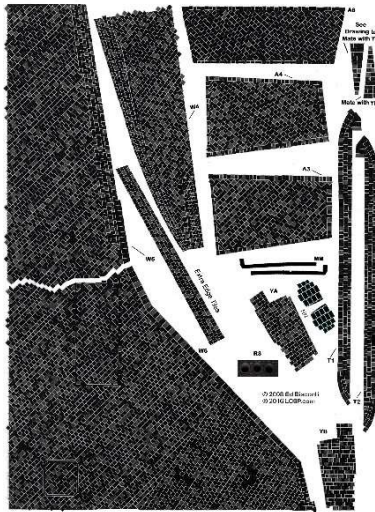
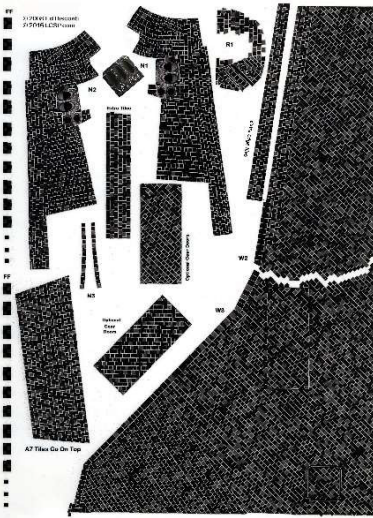

Early Era Space Shuttle White Tile Decal Set - 1/72, 1/100 & 1/144 scale

STS-ETD-1-72 for 1/72 - \$40.00 - STS-ETD-1-100 for 1/100 - \$30.00 - STS-ETD-1-144 for 1/144 - \$20.00

The Lake County Space Port “Early Era” Orbiter Upper TPS Decal Set includes all of the “white” Thermal Protection System (TPS) areas, and other special detail areas, which are common to both early-era Space Shuttle Orbiters - OV-101 “Columbia” and OV-099 “Challenger.” The set includes the following TPS areas:

- Crew Compartment Top & Side Surfaces (cockpit area & Orbiter sides)
- Forward Fuselage Surfaces (forward for Cockpit to nose Black tiles)
- Mid-Body sides (below Payload Bay Doors)
- Payload Bay Door Lower surfaces
- Port & Starboard Wing Upper Surfaces Vertical Stabilizer Sides
- OMS Pod front surfaces

The set comes with sheets of specifically designed white tile decals and one half-sheet of generic “white tiles,” to use as replacement stock or to work the OMS Pod front tile coverings and a multi-page instruction guide, which includes Shuttle external marking location data, provided with support of Mr. Alfonzo Moreno of [AXM Paper Space Models](http://www.axmpaper.com).



The Early Era TPS Decal Set must be paired with the Standard Tile Decal Set to complete the overall TPS system for the specific early Orbiter you are modelling.

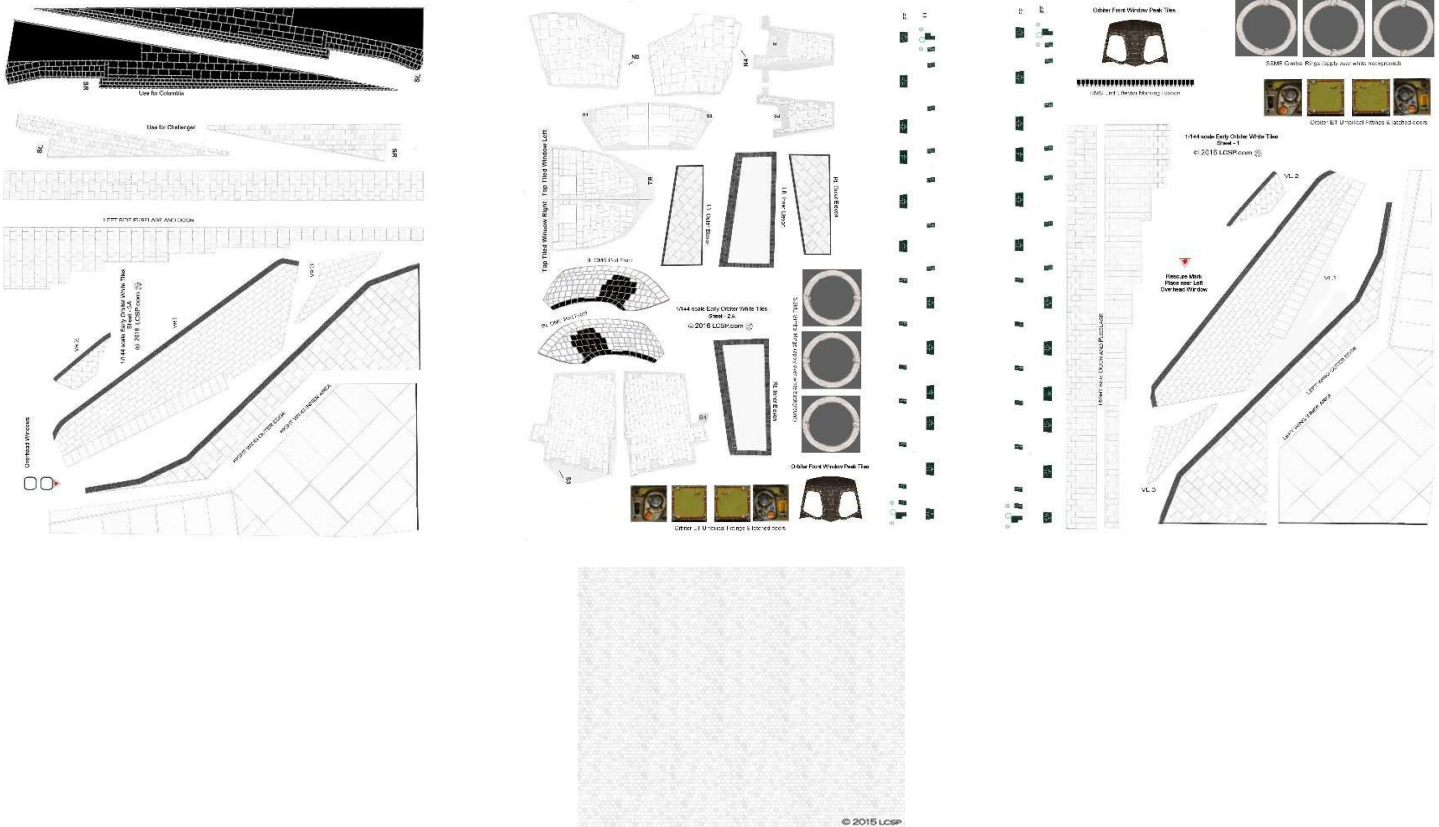

Late Era Shuttle AFRSI & White Tile Decal Set - 1/72, 1/100 & 1/144 scale

STS-LAD-1-72 for 1/72 - \$50.00 - STS-LAD-1-100 for 1/100 - \$40.00 - STS-LAD-1-144 for 1/144 - \$20.00

The 1/72 scale Late Era Shuttle AFRSI & White Tile Decal Set is being offered as an alternative to doing the Johnson & Johnson tape-based AFRSI Application Process.

You will need to properly pre-paint the model with the proper base colors.

By combining the Standard Shuttle Tile Decal Set and the AFRSI & White Tile Decal Set, you can complete your model's Thermal Protection System.

To create these decals, I found documents published by United Space Alliance (USA), the former Shuttle processing contractor, which contained drawings of the port side of the Orbiter's forward section (hatch side), as well as the port side Mid-Body. I was also able to find a drawing of the vertical stabilizer, in a very low-grade of resolution. Using these drawings as "feed stock," I revised the original 1/72 scale white tile nose sections for the Shuttle Tile Decal Set, re-did the artwork for the vertical stabilizer, added "strip sections" of AFRSI for OMS Pod work and other "touch-ups," added the "still required" sections of the original Shuttle White Tile decals for the area around the cockpit windows, included a properly tiled front window "peak" decal and printed the whole set on Clear Decal Paper stock.

The set includes sheets which contain the following TPS areas:

- White Tiles for Crew Compartment Top & Side Surfaces (cockpit area top & behind windows))
- White Tiled OMS Pod front surfaces
- Forward Fuselage AFRSI Surfaces (forward for Cockpit to nose Black tiles)
- AFRSI for Mid-Body sides (below Payload Bay Doors)
- AFRSI for Payload Bay Door Lower surfaces (above door edge)
- AFRSI for Port & Starboard Inner Wing Upper Surfaces and AFRSI Panels behind the leading edges.
- AFRSI for Vertical Stabilizer Sides
- AFRSI for OMS Pod rear access panels
- Additional AFRSI strips for repairs and completion of the OMS Pod surfaces.
- New corrected Upper Wing Surface AFRSI Panels and Elevon Hinge Covers for specific Orbiter periods, provided by Michael Mackowski of [Space In Miniature](#).

The Late Era AFRSI & White Tile Decal Set must be combined with the Standard Tile Decal Set to complete the overall TPS system for the specific early Orbiter you are modeling.

The set comes with a multi-page instruction guide, which includes Shuttle external marking location data, provided with support of Mr. Alfonzo Moreno of [AXM Paper Space Models](#).

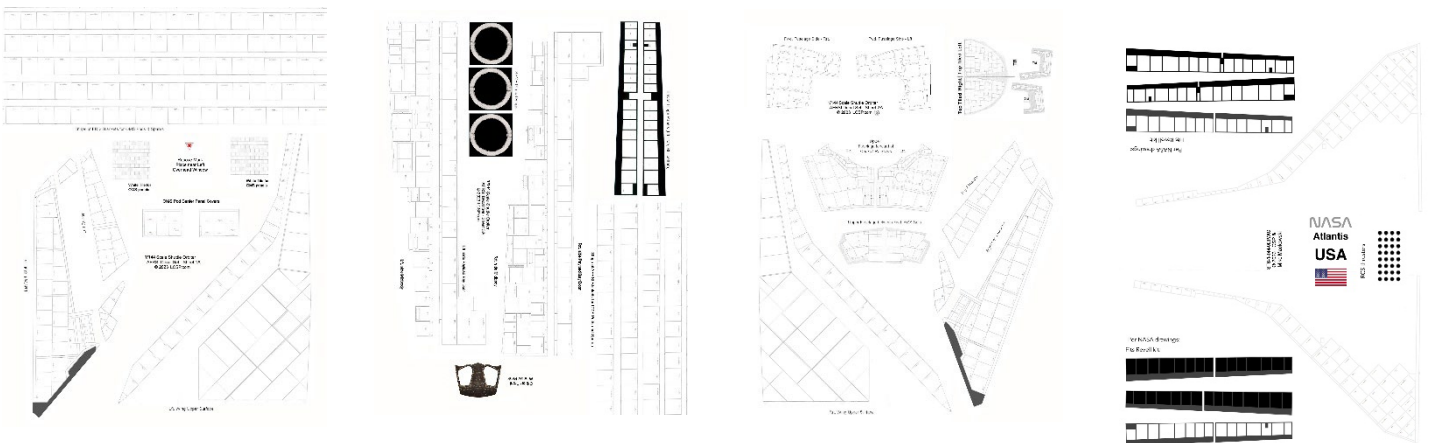

Late Era Shuttle White Tile Decal Sheet (available in 1/72 scale only)

STS-LTD-1-72 - \$20.00

The Lake County Space Port Late Era Shuttle White Tile Decal Sheet is **intended to be used in conjunction with the Johnson & Johnson Cloth Tape AFRSI Application Method.**

The sheet includes the “white” Thermal Protection System (TPS) areas, and other special detail areas, which are needed for all late-era Space Shuttle Orbiters - OV-103 “Discovery,” OV-104 “Atlantis” and OV-105 “Endeavour.”

The set includes one full-size sheet which contain the following areas:

- White Tiles for Forward Fuselage & Crew Compartment (cockpit top, body areas behind and in front of cockpit windows)
- White & Black Tiled OMS Pod front surfaces
- Forward Fuselage Upper Surfaces (forward of Cockpit windows)
- Port & Starboard Wing Upper Surfaces
- Port & Starboard Wing Hinge Panels
- SSME Gimbal Seal Rings
- Orbiter/ET Umbilical Panels and Umbilical Door Interior Surfaces

The Late Era White Tile Decal Sheet must be combined with the 1/72 scale Shuttle Standard Tile Decal Set and the Johnson & Johnson tape-based AFRSI Application Process in order to complete the overall TPS system for the specific late-era Orbiter you are modelling.

The decal set is printed on Clear Decal Paper Stock.

All decals are printed using Clear Decal Stock, so proper pre-painting of the Orbiter must be done prior to applying the decals. Please read the decal set instructions for details.

LCSP recommends the use of the 1/72 scale AMP Shuttle Window Set for all high-resolution Orbiter models. Just Google "AMP Shuttle Windows" to find their website.

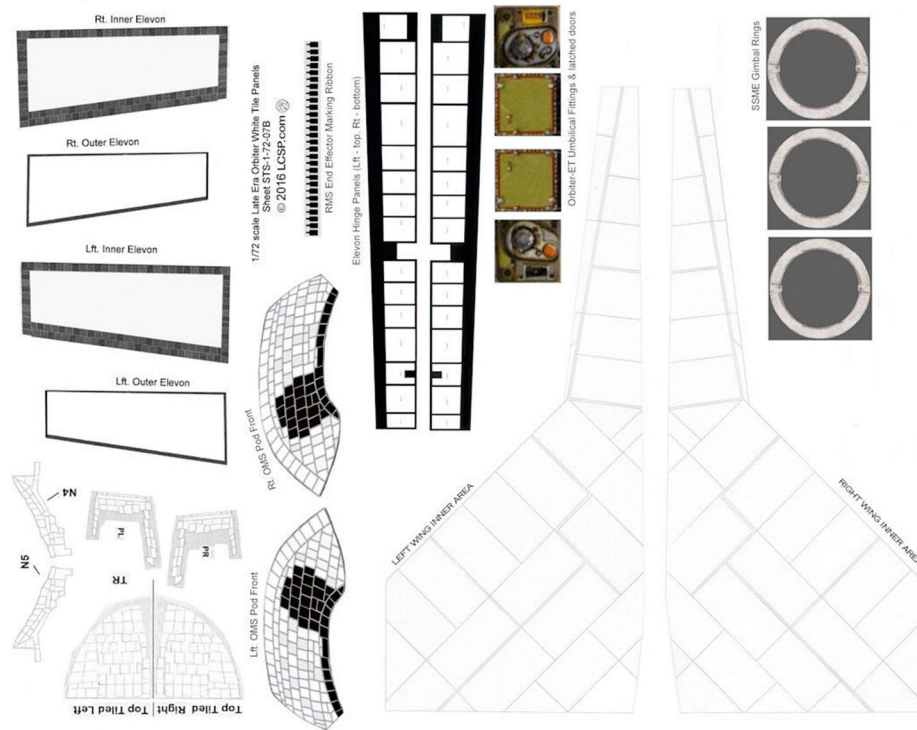

Space Shuttle Orbiter Flexible Thermal Protection System Replication Process for 1/72 & 1/144 scale models.

STS-FTPS-PDF – FREE PDF File – Downloadable from Website Store

This is a concise guide on the Flexible Reusable Surface Insulation System (FRSI) process I created to do the FRSI "blanket" type thermal protection system on the last three Orbiter models I've built and profiled on my website – LakeCountySpacePort.com.

The guide provides the background of how the process began, tips on the creation and application of the surgical-tape-based "blanket" sections, and the maps I have created to provide the locations for the different sizes of FRSI blankets onto the surface of the Orbiter, based on both NASA and personally-shot photographic data.

While my original work was done in 1/72 scale, reducing the dimensions of the blanket components by 50% will allow the same process to be applied to 1/144 scale models of the Orbiter as well.

Click on the "\$00.00" price link below to start the FREE download of the Guide in PDF format. (Adobe Reader or Acrobat is required to use this file.)

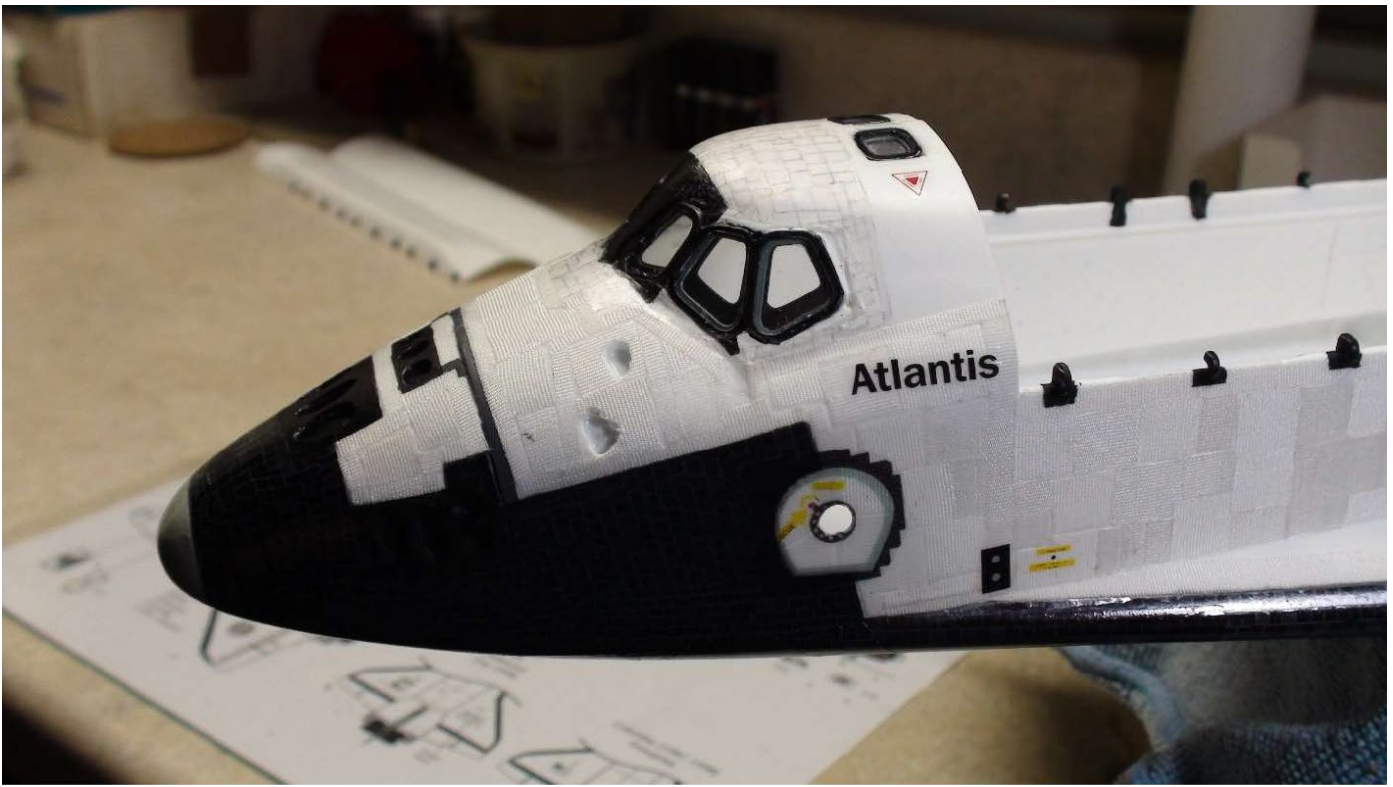

Space Shuttle Payload Bay Surface Detail Set - 1/72, 1/100 & 1/144 scale

STS-PDS-1-72 for 1/72 - \$25.00 - STS-PDS-1-100 for 1/100 - \$20.00 - STS-PDS-1-144 for 1/144 - \$15.00

The Space Shuttle Payload Bay Detail set you are looking at are scaled to fit the components of the 1/72 scale Monogram/Revell Space Shuttle Orbiter models, either as the Orbiter alone or as part of the Monogram 1/72 Space Shuttle "stack."

The images used to create the applications were pulled together from hours of research into NASA photographs of Shuttle operations within the Orbiter Processing Facility during servicing and payload installation or removal.

This detail set does not provide the same elements as other Payload Bay "Upgrade" set previously sold by other modeling suppliers. It attempts to create a "photorealistic" interior surface to the Orbiter's Payload Bay.

The set provides pressure-sensitive applications for the forward and aft bulkheads of the Payload Bay, applications for the Payload Bay Floor and Side Panels and applications for the aft end of the Bay's Wiring Chases, which are already molded into the floor element of the Monogram Model's Payload Bay.

These elements are printed onto the self-adhesive material and must be "trimmed down" using a sharp hobby knife, such as an X-Acto #11 knife blade, so this detail set is recommended only for experienced modelers.

The set also provides instructions on necessary additional items needed to do the job, tools needed, and proper installation of the applications and user provided plastic stock materials.

The photographs supplied provide an indication of how well the detail set works. These items were originally made for the two Monogram 1/72 scale Shuttle Orbiters I am currently working on. We are very proud to offer these on our own website LakeCountySpacePort.com.

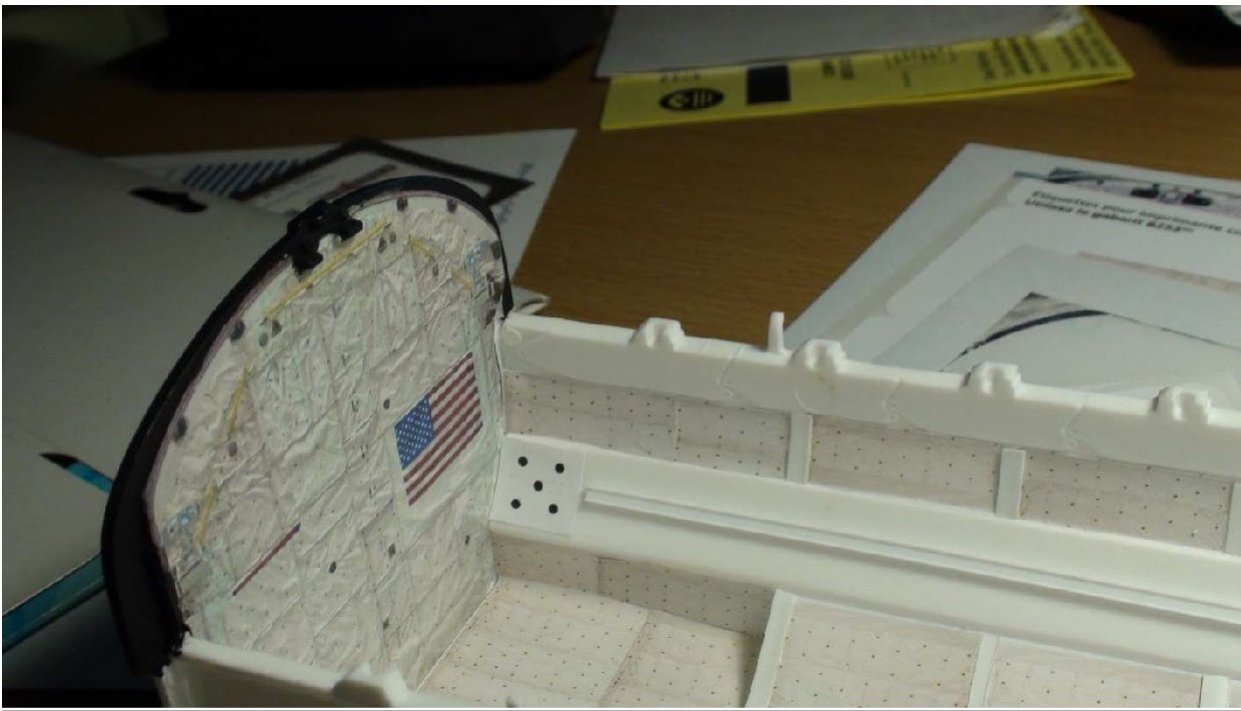

Space Shuttle Detail Application Set –

1/72, 1/100 & 1/144 scale.

- [STS-DAS-1-72 \(1/72 scale\)- \\$20.00](#)
- [STS-DAD-1-72 Decal-based \(1/72 scale\) - \\$25.00](#)
- [STS-DAS-1-100 \(1/100 scale\)- \\$20.00](#)
- [STS-DAS-1-144 \(1/144 scale\) - \\$15.00](#)

The Space Shuttle Detail Application Set is a unique set of applications designed to help make your spacecraft model more historically accurate. Each shuttle has unique marking arrangements and so you should research the photos online and offline in books to accurately replicate the spacecraft you desire to model.

The 1/144, 1/100 & 1/72 sets have application elements for the following locations:

- The instrument panel surfaces of the Orbiter Flight Deck.
- The Intertank Service Access Panel and Gaseous Umbilical Carrier Plate fitting for the External Tank
- The Main Engine Gimbal Seal Rings for the Aft Bulkhead
- Orbiter/ET Umbilical Doors and Fittings
- Main Engine Close-Out Covers for the openings of the Space Shuttle Main Engines.

Since there is no 1/100 scale Shuttle "Stack", the 1/100 scale set offers ESA MPLM markings (for the revised Tamiya kit) and no ET markings.

We also provide very small red rubber bands to replicate the draw cords used to hold the covers on the engine bells.

The original set is printed on white, self-adhesive label stock.

Alternate versions use white water-slide decal stock.

All markings must be carefully cut out for placement onto the model. As such, these sets are only recommended for experienced scale modelers.

All applications are printed on gloss white label stock.

These elements must be "trimmed down" using a sharp hobby knife, such as an X-Acto #11 knife blade, so this detail set is recommended only for experienced modelers.

Example applications can be seen on the 1/72 STS-134 "Endeavour" build, shown here, except the MPLM Markings.

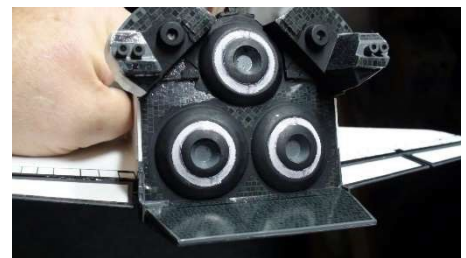
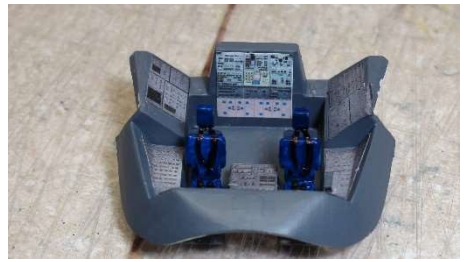
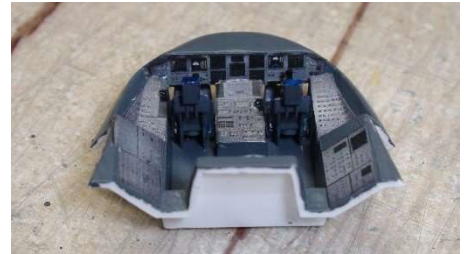

1/144 scale Revell International Space Station Detail Application Set

ISS-EDS-1-144 for label-based set - \$70.00

ISS-EDD-1-144 for decal-based set - \$80.00

This application set comes with all of the printed panels indicated in these instructions, plus some spares in case you run into difficulties. The set includes:

- Main ISS Solar Array applications, front & back (16 each total – no spares)
- ATV Solar Array application, front & back (8 each total - 4 each needed)
- Russian Zvezda Module Solar Array applications (2 each total – no spares)
- Russian Zarya Module Solar Array applications (2 each total – no spares)
- JAXA Kibo Lab external pallet bottom surface application (2 total – 1 needed)
- JAXA Kibo Lab external module bottom surface applications (2 total – 1 needed)
- Unity and Tranquility Open Hatch Covers (4 total – no spares)
- Cupola window applications (6 wedge-shaped, 1 round – no spares)
- Module marking plate (some spares)
- “Dot” marker panel – (many spares)
- Soyuz/Progress Solar Panel Top panels (8 each – 2 spares)
- Soyuz/Progress Solar Panel Bottom panels (8 each – 2 spares)
- 10-page instruction manual

The concept of “photo-realistic” modeling, promoted by Edu-Craft Diversions and their incredibly elegant heavy-paper models, has stayed with me and became the genesis of many of Lake County SpacePort’s product offerings. This one is no exception.

The patterns on the Revell Germany ISS main solar panels as supplied made painting by hand very time consuming and does not yield the correct look for the panels as they exist on the Station.

We used NASA ISS photos to achieve the correct look. We found photos of the Main Solar Arrays and the Russian Solar Panels that provided graphic data to fabricate direct-application panels to do those jobs.

I also found other areas of “opportunity” where good photo detail data was available. These would add even more depth and detail to the finished model. There are also provided to you for your use, as tried and proven on my ISS model build. They are available in the original Avery label-stock printed version, or now on white water-slide decal paper printed versions, which cost more to produce.

The basic rules of use, as well as guidance on the rest of the model, is provided in a 10-page illustrate instruction manual, provided with the set.



1/92 scale Atlas V Launch Livery Decal Set

For use with the Real Space Rockets 1/96 scale
Atlas V (AV422) & Boeing CST-100 Model Rocket Kit

RSR-AMD-1-92 - \$8.00

These Atlas “livery markings” are based on artwork done in 2016 by Boeing to show the CST-100-Centaur configuration, just after achieving orbit.

The markings are based on the actual set of program logos that are typically placed onto an Atlas V launch vehicle for each mission.

They usually depict the agency in charge of the flight (NASA, U.S. Air Force, NRO, etc.) the Atlas program insignia and the payload contractor (Boeing, in this case). In this case, the NASA Commercial Crew Program Office logo and the United Launch Alliance logo were added by the artist. As the Centaur stage tube wrap of the model already provides the U.S. Flag, we did not repeat it in our decal markings.

We have also provided the “Boeing Starliner” marking for placement onto the exterior of the CST-100 spacecraft, at the locations shown. Using the Boeing artwork on the right, we have also provided “updates” to the CST- 100 paint scheme, to more accurately replicate spacecraft, according to the currently depicted Boeing artwork, and the detail provided on the model.



1/6 scale MMU Detail Decal Set

For use with the Revell 1/6 scale Shuttle Astronaut with Manned Maneuvering Unit Model Kit

STS-MMU-1-6 - \$24.00

The Revell Shuttle Astronaut with MMU Model Kit was originally released back in 1984, when Mission Specialist Bruce McCandless flew a Martin Manned Maneuvering Unit over 300 yards away from Space Shuttle Challenger, becoming the first human in history to conduct an un-tethered EVA (spacewalk) from an orbiting spacecraft.

Revell used a prior astronaut model kit from the Gemini Program as the basis for this kit, so unfortunately, the details of the spacesuit are a bit wanting. While the scaled MMU is essentially accurate, it also lacks details which create a more realistic representation of the actual hardware.

Using NASA archival photos, 3D models and our own photos shot at Kennedy Space Center and Space Center Houston, we were able to obtain highly detailed images of the MMU and translate those details into a set of water-slide decals, used on our own Revell Astronaut/MMU model renovation efforts. They are now being offered to help you with your MMU modeling project.

The set is first and foremost, a set of decals which can be used to dramatically increase the visual detail of the MMU, as well as the astronaut figure. The full- color decals are printed on white-background decal stock, to stabilize all the colors. They should be applied onto a Gloss White base color for best color match and decal adhesion. The completed decal installation can later be overcoated with a satin or flat finish coat, at your discretion.

The illustrated instructions also provide photographs of the scratch-built added detail items we made to improve the accuracy of the space suit, including detail of the helmet-mounted lighting and camera assembly, as well as the EMU Chest Control Pack. You can use these as reference for your own work.

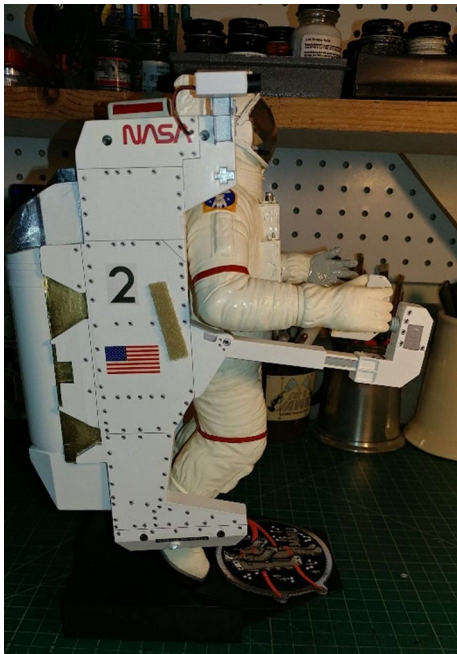

1/9 scale Detail Decal Set for the Dave Bowman Astronaut Figure

For use in the Moebius 2001 EVA Pod Model



EVA-DBS-196 - \$5.00

These decals were gleaned from images available on the Internet, illustrating specific elements of the Space Suits worn by the lead character actors in Stanley Kubrick & Arthur C. Clarke's masterpiece, "2001 – A Space Odyssey."

The astronaut figure we used was designed specifically to match the interior of the Moebius EVA Pod Model by Max Grueter, an artist and 3D sculptor from Switzerland, who specializes in Space Suits and Space-related figures and operates an outlet for production and sales of these on the Shapeways.com website, under the store name "Figurative Parts - Open Edition by Max Grueter."

While the figure is incredibly detailed, it still needs to be painted and finished by the modeler, prior to installation into the Pod.

In the construction of our own Moebius Pod model, we wanted to add more realism to the figure. We were able to find items through a search of the Internet. We created a set of decals for our own model and found they looked quite good.

The photos of the results were posted on Facebook with good response from other modelers. Hence, the creation of this product.

We have also included the USAA helmet decals, arm patch, chest pack decal and backpack decals and the details of the "Memory Cards" on the back of the astronaut's helmet.

Also, a set of details that can be used in lieu of "hand-painting" detail lines into the recessed areas on the front areas of each RCS "muff," provided as "bonus decals" to use at your own discretion. "Back-Up elements, or "spares" of all decal items are also provided.

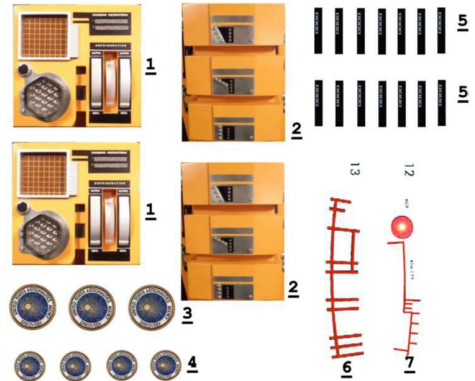



1/86 scale Dragon 2 Nose Cone Decals
for the Boyce Aerospace Hobbies
SpaceX Falcon 9 Version 2 flying
model rocket

The Boyce Dragon 2 nose cone is a nice piece of 3D printing that brings the SpaceX Falcon 9 Flying Model Rocket "up to date" by placing the new Crew Dragon, or Dragon 2 atop of it.

Our decal set uses artwork originally provided by Alfonso Moreno of AXM Paper Space Models as part of the "In-Flight Abort" paper model of the Falcon 9 / Dragon 2 combination that flew that final SpaceX test flight. Our goal was to take a fundamentally well-made model product and bring it closer to a more realistic look.

SPX-DDS-1-86 - \$9.00



1/86 scale Dragon 2 Nose Cone Decals for
the Boyce Aerospace Hobbies SpaceX Falcon 9
Version 1 and 2 flying model rockets

The Boyce Dragon 1 nose cone is a nice piece of 3D printing that brings the SpaceX Falcon 9 Flying Model Rocket "up to date" by placing an accurately scaled Cargo Dragon, or Dragon Version 1, atop of it.

Our decal set uses artwork originally provided by Alfonso Moreno of AXM Paper Space Models as part of the "CRS" paper model series of the Falcon 9 / Dragon 1 combination that flew that final SpaceX Commercial Re-Supply flight of the original SpaceX Dragon. Our goal was to take a fundamentally well-made model product and bring it closer to a more realistic look.

SPX-D1D-1-86 - \$9.00



1 T-38A Talon S/N : N923NA, One of the chase Aircrafts for Space Shuttle "Columbia" during STS-3 Mission, White Sands Space Harbor, New Mexico, USA, 30th Mar. 1982

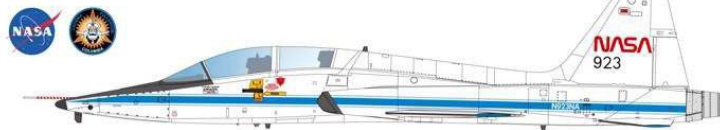

2 T-38A Talon S/N : N864NA, NASA Dryden Flight Research Center, Edwards AFB, USA, May 2006

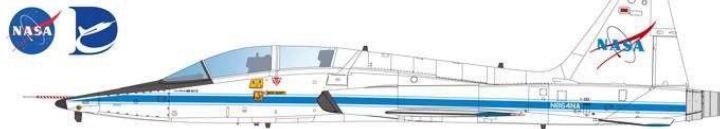

1/72 scale NASA T-38C Decal Set

The Trumpeter 1/48 scale T-38C is an excellent rendering of the famous Northrop jet trainer used by NASA as a chase plane and for flight crew flight proficiency.

The Trumpeter model was produced in 1/48 scale. We had been contacted by one of our past customers, who knew we worked with a number of NASA liveries, asking if we had access to any NASA T-38 decals in 1/72 scale. A number of companies used to have these on the market but recently, they have been almost impossible to find.

So, we took our 1/48 scale decals and re-scaled them down to 1/2 size - which is 1/72 scale.

NASA-T38-1-72 - \$6.00

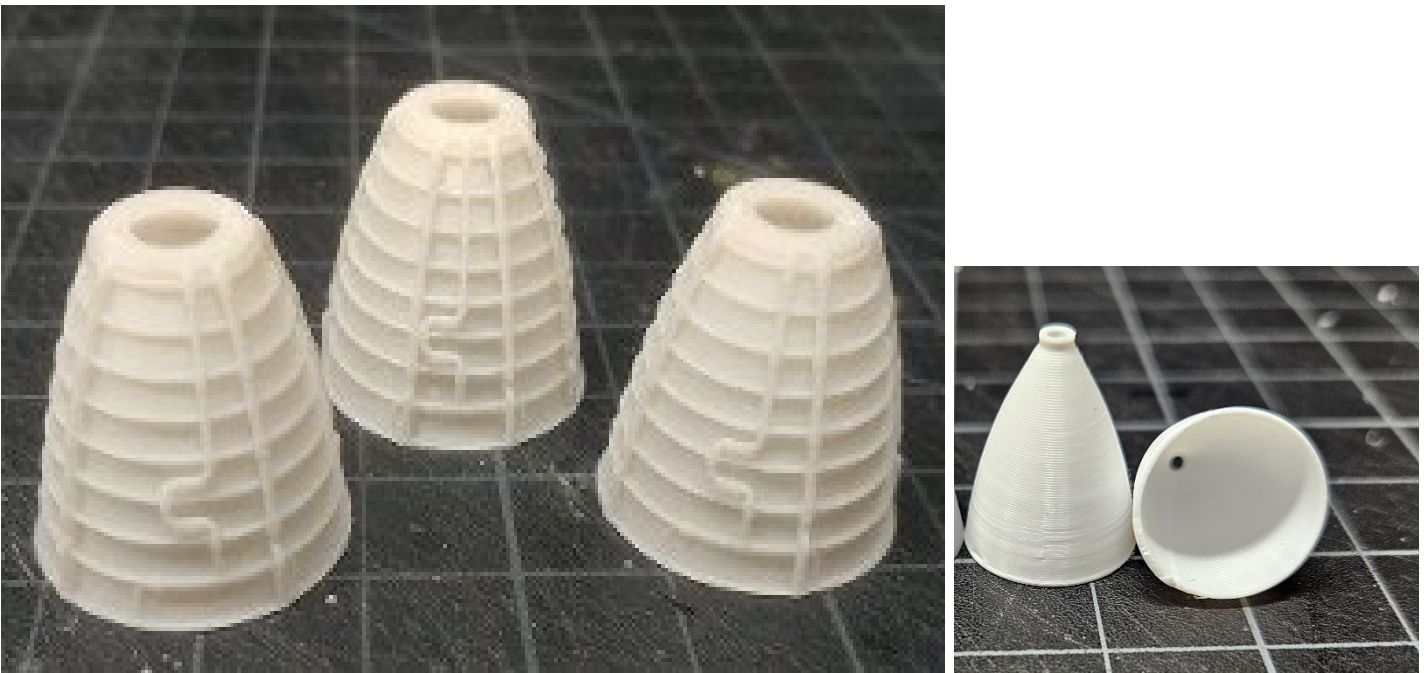

3D-Printed Space Shuttle Main Engine & Orbital Maneuvering System Replacement Set for all 1/72 scale Orbiter models & Tamiya 1/100 scale Orbiter models

(SKU #STS-SME-1-72 & STS-SME-1-100)

The Space Shuttle Main Engine (SSME) & Orbital Maneuvering System (OMS) Replacement Set is the result of a significant amount of research, both in available 3D models of the engines and in the correct information about engine orientation in the Aft Thrust Structure of the Orbiter. They are offered to solve one of the only “nagging problems” with many Shuttle Orbiter scale model kits – The Space Shuttle Main Engines & OMS Engines provided as part of the kit.

Evidently, some model makers worked from photographs and drawings of early “developmental” SSMEs, shown in NASA publications early in the Shuttle’s development and ground testing. Some kits still even have the “loops” in the engine coolant transfer ducts, near the bottom of the nozzle. This configuration was modified to reduce vibration stress and achieve higher reliability and does not reflect engines used as flight hardware.

The 3D model for these engines was obtained from “In3DSpace,” who used NASA 3D model files, openly accessible and available from the NASA.gov website. The In3DSpace model was truncated to the “nozzle section,” from the Heat Shield attachment ring down. The OMS Engine nozzles are scaled in accurate proportion to the SSMEs.

The sets include three (3) SSME nozzles and two (2) OMS nozzles. A full-color, four-page manual provides proper engine orientation as well as color image references for detail painting.

Price: \$30.00 (1/100 scale)

\$40.00 (1/72 scale)

Shuttle Flight Deck Window Sets

Our reproduction of the original AMP-Australia product, now in 1/144, 1/100 & 1/72 scales

The original AMP (Australia) Shuttle Window Set was available for several years, directly from AMP. In recent years, AMP had closed its website and stopped all sales and distribution of their products, including the Shuttle Flight Deck Window Set.

As demand for this product still existed in the modeling market, the SpacePort decided to attempt "recreating" its own version of the original AMP Window Set, so that Shuttle Modelers could still obtain a usable copy of the only Shuttle Window system to visually replicate the apparent thickness of the windows used on the Orbiter's flight deck. There are significant differences between our recreated set and the original.

First, the original set was furnished with either "die-cut" or "laser-cut" sheets of white and clear styrene, which provided the frame and glazing parts to make the windows. Our frames are Laser-cut, using a Crealitty CR Falcon Laser Cutter/Engraver, using 0.015" thick white styrene plastic sheet stock.

We provide the same elements provided in the original AMP product:

- A set of six frames that combine with intervening clear elements to create the Port and Starboard side Front Cockpit Windows.
- A set of six frames that combine with intervening clear elements to create the two Aft Overhead Windows.
- A set of four frames that combine with intervening clear elements to create the Payload Bay-facing Aft Windows.

Our frame elements are provided still partially attached to the sheet section from which they are cut. The laser cuts through most of the styrene, so a light touch with an X-Acto knife and a bit of pressure will "pop" them loose from the sheet. This can also provide support for the frames during painting.

Templates for the Forward Windows and the Aft Windows are provided. They are laser-cut made from 80 lb. white card stock.

Since it is not possible to cut clear plastic sheet with a laser cutter, we provide an appropriately sized section of 0.010" clear styrene stock, which has been "etched" by the heat of the laser, leaving a pattern allowing the user to cut out the clear sections for assembly.

Full-color instructions are provided.

Price - STS-FDW-1-144 - \$10.00
STS-FDW-1-100 - \$12.00
STS-FDW-1-72 - \$15.00

FLIGHT DECK WINDOWS

The AMP set is designed from the 1/100 page of our new Shuttle Crew Operations Manual. Small adjustments were made for scale and kit limitations.

The six (6) forward windows (without side) were made from three separate glass sets. The glass sets are thickened top and bottom by cover pieces on all four horizontal edges. The top is 900P and the bottom is 900B. The cover pieces are clear, leaving about 1/16" from the top and bottom.

The outer pane was 18mm (0.822") thick and rounded to fit fuselage. The exterior face could not hold 420C (900P). It is a clear face (outer pane) is not thicker.

The center pane was 33mm (1.27") thick, made of fused silica glass. It was mounted to the crew compartment.

The inner pane was 18mm (0.822") thick, mounted to the crew compartment. It could not hold 420C (900B) or 420B (900B). The outer face had an anti-reflective coating. Each pane had redundant seals, but no sealing or bonding compounds.

NOTE: The AMP set (1/100 scale) had a 6mm (0.236") gap between the panes. The gap between panes is suggested out of our product as well. The and cover pieces are not the same thickness as the original.

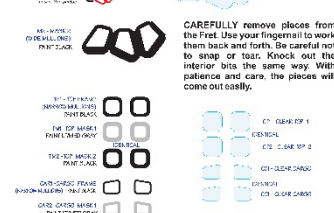
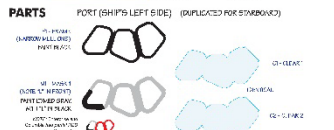

CAREFULLY remove pieces from the fret. Use your fingernail to work them back and forth. Be careful not to snap or tear. Knock out the interior bits the same way. With patience and care, the pieces will come out easily.

Accurate Model Parts (AMP-Australia)
 SPACE SHUTTLE STS Flight Deck Windows 1/72
 © Alan Cooney SpacePort Falcon 14, 10/2010
 www.spaceportmodel.com

WINDSHIELD

1 BEND FRAMES & MASKS

BEND each of the 8 frames and masks separately. (Please allow 24Hr to stabilize and return to normal before use - you can also use a vehicle light edge to PAH the first window, as it is a severe angle, or if that is not possible, use a low angle. Use thick window and hold it in position. NOTE: to avoid scratching the clear plastic between each frame paper or solution.

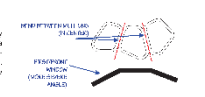

2 PAINT

Lightly sand and paint. Use the Panes lid as a guide. You may want to apply clear Future Floor Wax or to the clear parts in your chosen sequence.



3 PRE-ASSEMBLY

Separate frames and clear pieces together as separate sub-assemblies.

SUB1 - Clear T1 (FRAME) TO CLEAR T1. The easiest technique is to clamp with thin strips of masking tape into both sides of the substrate ONLY.

SUB2 - Masked SUB1 TO SUB2. SUB2 NOTE: We suggest PVA/White glue as it is clear. Clear Glue dries over time clear. You can also use Future Liquid Floor Wax. DO NOT use CA/Superglue - will cause and tear the film.

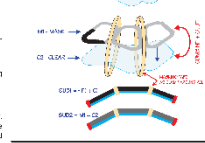

ON YOUR 1/16" DOTS OF CLEAR SUPPLEMENT THIS POINT.

4 FINAL ASSEMBLY

COMBINE SUB1 - SUB2 + SUB3.

MASKING TAPE: Apply tape bands as changes, do also, pull the tape on the top and bottom edges of the window assembly for hold strength. When dry, remove all tape and the middle one where the tape was. You may want to apply a second coat of glue or adhesive strength.

If you choose Future as glue, once allowed to cure, it may, you may want to make your own: no need Clear Glue or PVA white glue.

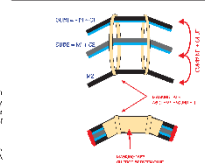

WINDSHIELD (Cont'd)

5 INSTALL

Use the STS-FDW-1-144 (1/100) or STS-FDW-1-100 (1/100) to verify the hole size. Use the cockpit window hole.

CUT OUT the glass to fit the hole assembly.

USE the window into the new changed and shaped hole. You will need to fill the gaps from the original hole with epoxy or pieces of the correct mask.

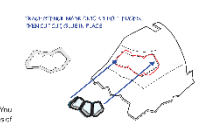

TOP WINDOWS

The same sequence of panes applies, glue T1 to T1 and T1 to T2. Then glue the bottom mask together with T1 and T2.

FIT into existing hole (you may have to enlarge, hole slightly, and early version.)

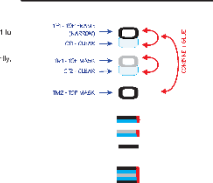

CARGO WINDOWS

The same sequence of panes applies, glue C1 to C1 and then seal CARGO on the bottom.

FIT into existing hole (you may have to enlarge, hole slightly, and early version.)

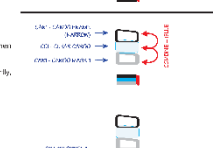

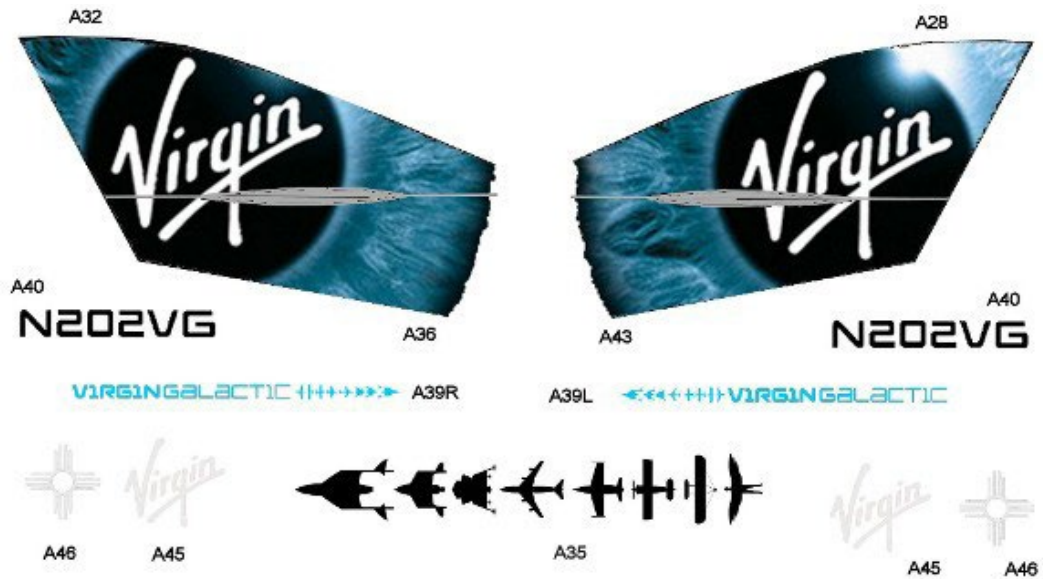

VIRGIN GALACTIC "VSS UNITY" LIVERY MARKING DECALS
FOR THE REVELL GERMANY 1/144 SCALE
"SPACE SHIP 2 AND WHITE KNIGHT 2" MODEL KIT

(SKU #VSS-SS2-1-144)

We originally created this decal set to do our own Revell Virgin Galactic model project. With the photos of our results out on the Web, we've received several requests for these decals, so we're now offering them as a standard product.

The decals include the tail boom "Virgin" nebula logos, New Mexico "Zia" symbols & Virgin logo in soft Gray for each side of the tail near the rocket engine, correct side Virgin Galactic livery markings, correct aircraft registration numbers (for VSS Unity) and a "back-up" copy of the "Evolution of Flight" symbols for the top of the fuselage.

Remember, our decals are NOT a complete set. They must be used in conjunction with the decals furnished by Revell for the remainder of the SpaceShip and MotherShip Eve. Our decals are printed on clear decal stock and must be trimmed down before soaking and placement. Full color instructions are included.

Price: \$8.00



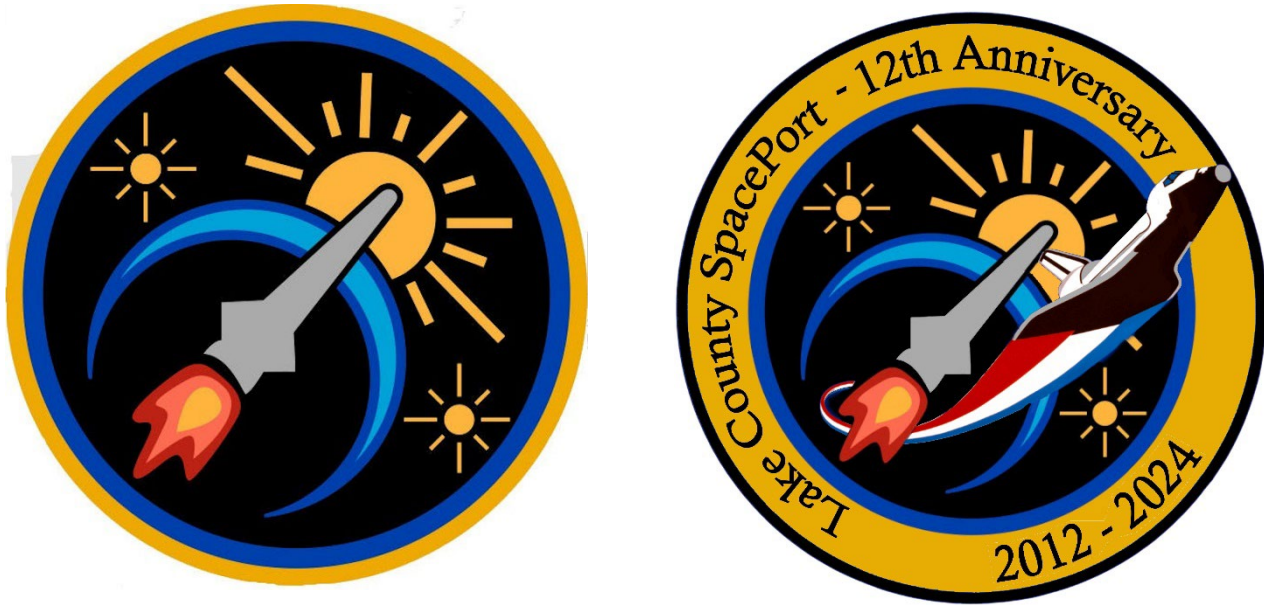

Lake County SpacePort Logo Patch – Original or 12 Year Anniversary Edition
Show you colors!!

LCSP-Patch - \$4.00 **LCSP-12YR-Patch - \$5.00**

A full color embroidered iron-on patch, depicting our historic logo, which symbolizes our motto – As Astra per Formae! – To the Stars by Modeling!

The 12th Anniversary Edition takes our long association with the Space Shuttle into consideration. Modeling the Shuttle Orbiter was the reason we started this whole thing, so we included artwork from the 12th flight of the Shuttle, STS-41D, which also happened to be the maiden flight of Shuttle “Discovery.”

Both patches are fully embroidered cloth patches with iron-on material on the back, for easy application onto your “flight jacket,” tee-shirt or any piece of apparel.

These are limited-production items. Get your today!



"All Lake County SpacePort products come directly out of our own modeling projects. They are tried, tested, and proven in our work, along with the most detailed instructions we can write, to help you succeed in your work."

A handwritten signature in black ink, appearing to read "Steven W. Jochums".

Steven W. Jochums